

| TOLERANZE IN CLASSE ESSE |        |
|--------------------------|--------|
| IT12                     | 0.015  |
| IT13                     | 0.020  |
| IT14                     | 0.025  |
| IT15                     | 0.030  |
| IT16                     | 0.040  |
| IT17                     | 0.050  |
| IT18                     | 0.063  |
| IT19                     | 0.080  |
| IT20                     | 0.100  |
| IT21                     | 0.125  |
| IT22                     | 0.160  |
| IT23                     | 0.200  |
| IT24                     | 0.250  |
| IT25                     | 0.315  |
| IT26                     | 0.400  |
| IT27                     | 0.500  |
| IT28                     | 0.630  |
| IT29                     | 0.800  |
| IT30                     | 1.000  |
| IT31                     | 1.250  |
| IT32                     | 1.600  |
| IT33                     | 2.000  |
| IT34                     | 2.500  |
| IT35                     | 3.150  |
| IT36                     | 4.000  |
| IT37                     | 5.000  |
| IT38                     | 6.300  |
| IT39                     | 8.000  |
| IT40                     | 10.000 |

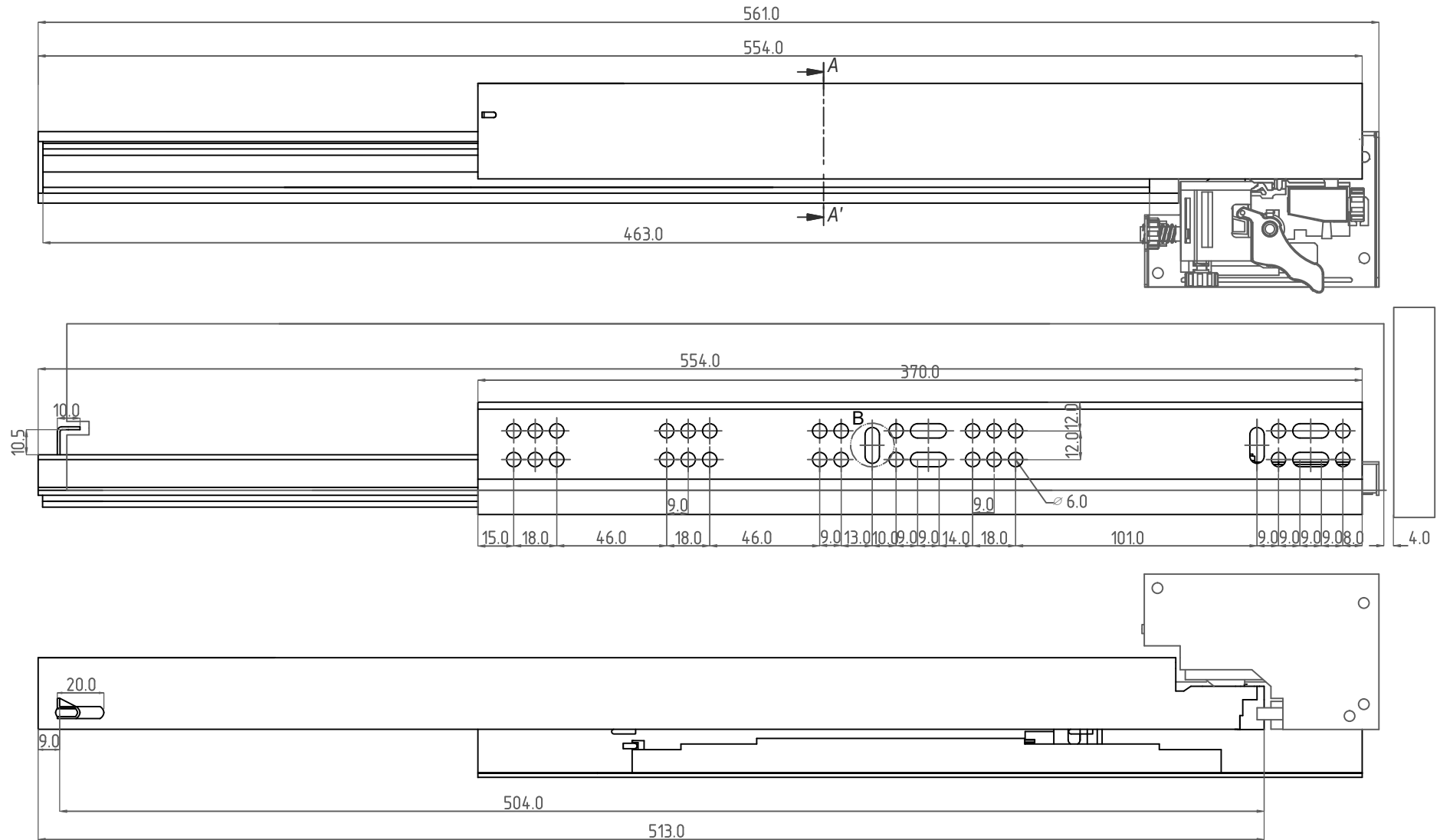

B (1:1)

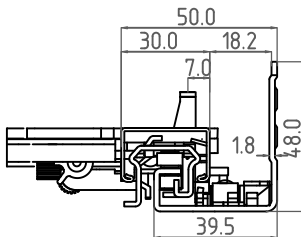
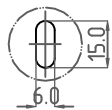

SEZ AA'

|  |                                      |                                      |                             |                 |
|--|--------------------------------------|--------------------------------------|-----------------------------|-----------------|
| DESIGNED BY<br>A. d'Alesio   | CHECKED AND APPROVED BY<br>T. Grassi | GENERAL TOLLERANCE<br>SS-ISO-2768-1M | DATE<br>13/02/2024          | CODE<br>Q53550  |
| <b>RAM</b><br><b>INDUSTRIE</b>   |                                      | DESCRIPTION                          | MATERIAL                    | UNIT<br>mm      |
|  |                                      | DEVICE                               | PACKAGING<br>Carton 1 piece | SHEET<br>1 of 2 |
| Property of RAM Industrie<br>Without its written authorization the present drawing shall neither be used for construction anyway, communicated to third parties, nor reproduced. |                                      |                                      |                             |                 |

THIS DRAWING IS THE EXCLUSIVE PROPERTY OF RAM INDUSTRIE (THE COMPANY).  
WITHOUT ANY PRIOR WRITTEN AUTHORIZATION OF THE COMPANY,  
REPRODUCTION, DISTRIBUTION, OR ANY OTHER INFORMATION  
TO ANY THIRD PARTY OR EVEN PARTIAL REPRODUCTIONS  
BY ANY MEANS IS STRICTLY PROHIBITED.  
THE COMPANY WILL LEGALLY DEFEND ITS OWN RIGHTS.

